

HOW TO RENEW YOUR SUBSCRIPTION (DESKTOP VERSION)

1. Open www.AlbertaBallet.com/MyAccount on your browser. On the My Account main page, select the **Profile** icon. Sign in to **My Account**.

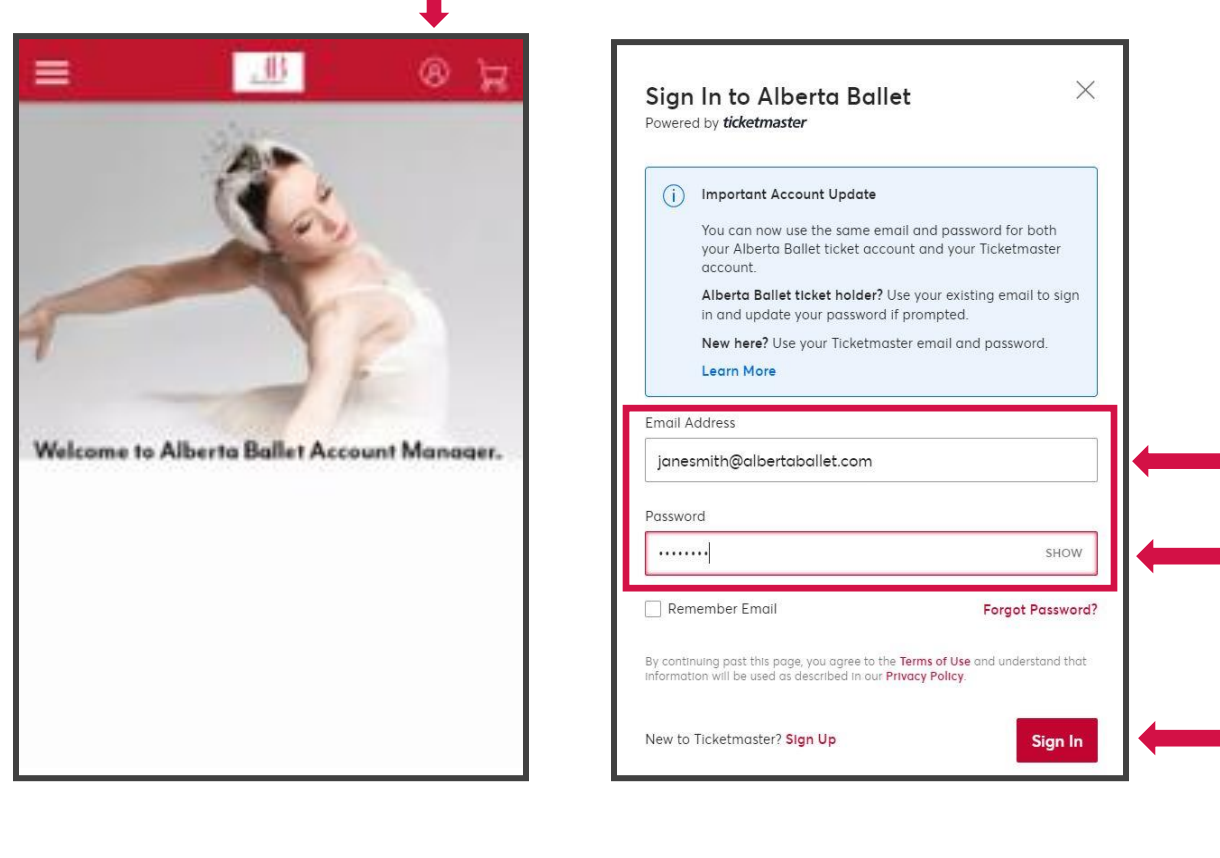

2. Once you are signed in, click on **Invoices** on the upper left corner of the Menu Bar.



3. Review your **Subscription Package Summary** (if applicable), then press **Continue**.

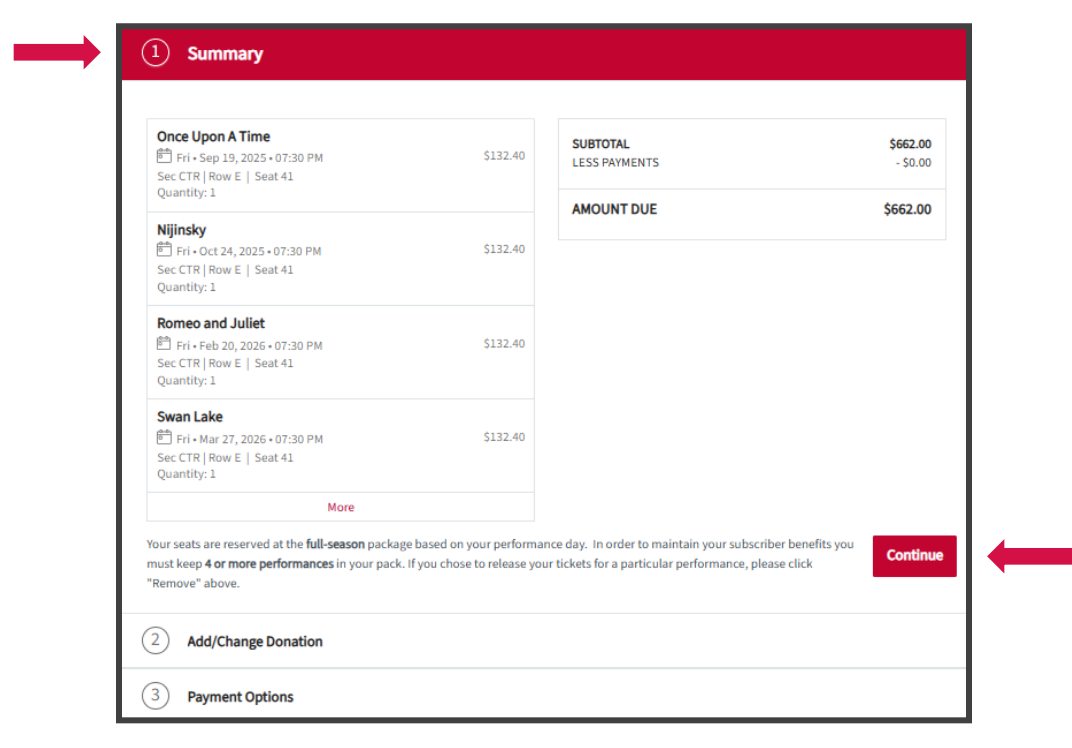

NEW THIS SEASON! You can now choose to **opt-in to Auto Renewal**. Select YES if you would like to opt-in. Your 25/26 season subscriber seats and payment schedule will be carried over to the 26/27 season. Select NO if you would like to opt-out of auto renewal. Click **Submit** to confirm your response.

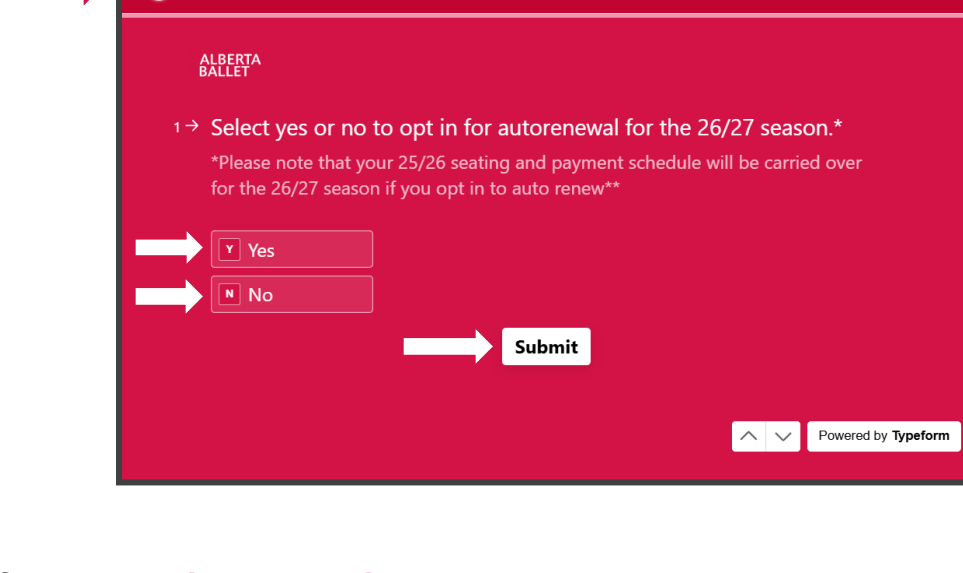

4. Consider **Making A Donation** to support Alberta Ballet and make a lasting impact on your dance community. For more information on Donations, click the **MORE** button on the side of each section. Enter **an amount** in the box, then click **Continue**.

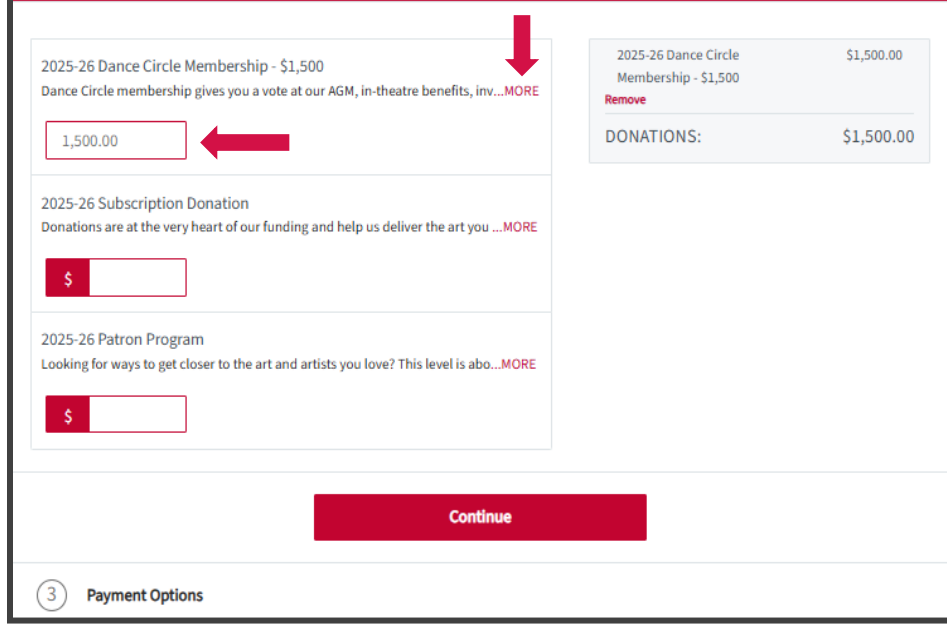

5. Select a **Payment Option** (Pay in Full; Monthly Payment Plan; Pay 50 Now, 50 Later). Click **Add Payment Method**.

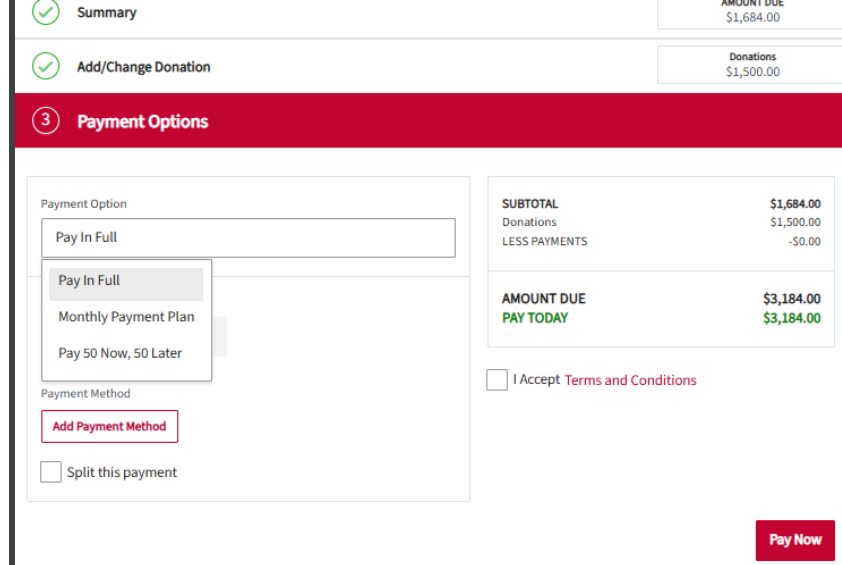

Select your **Payment Method**, then confirm the amount to be paid.

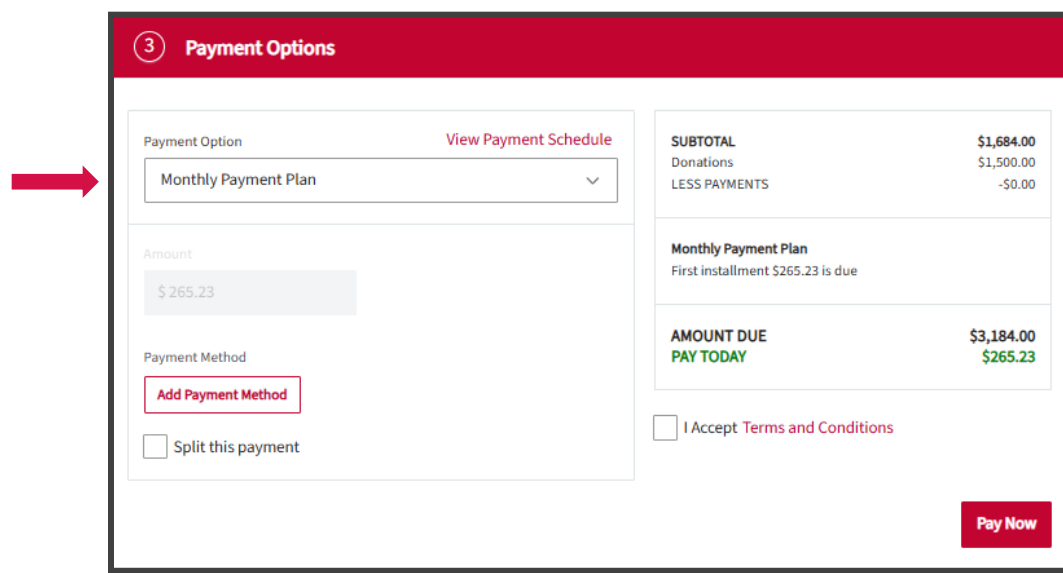

If you selected **Payment Plan** as your payment method, you can view the **Payment Schedule** in this section.

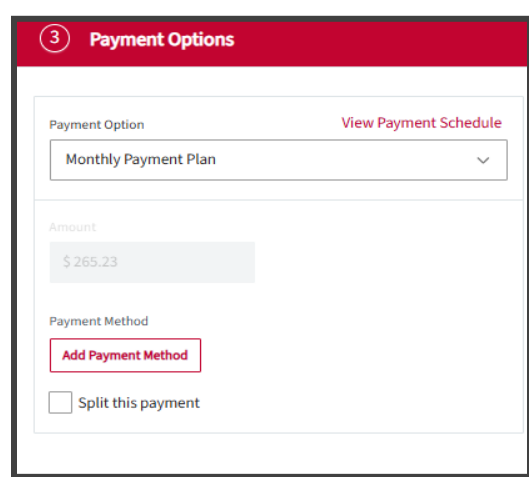

PAYMENT SCHEDULE	
Monthly Payment Plan	
Zero-interest monthly payment plan	
Requires 20% Down Payment Today	
PAYMENT SCHEDULE	
\$265.23	-
\$265.23	-
\$265.23	-
\$265.23	-
\$265.23	-
\$265.23	-
\$265.23	-
\$265.23	-
\$265.23	-
\$265.23	-
\$265.47	-

25/26 Subscription Payment Plan Schedule

6. Review your payment information. Check the box to accept the Terms and Conditions. Click **Pay Now** to complete the transaction.

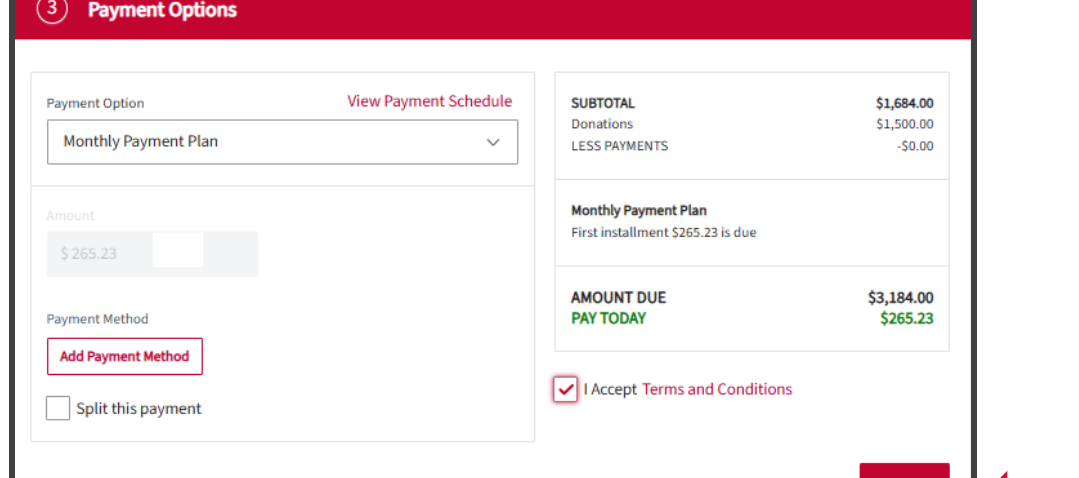

If you need additional assistance, Alberta Ballet's Patron Services Team is happy to help you. Call us at **1-800-646-8533 ext. 2** or email us at BoxOffice@AlbertaBallet.com